

AT THIS EARLY STAGE THE ENVIRONMENT AGENCY CANNOT GUARANTEE THAT WORK DETAILED ON THESE DRAWINGS CAN BE PROMOTED

River channel lowered by approximately 1 metre.

Existing arch bridge replaced with vehicular or pedestrian bridge.

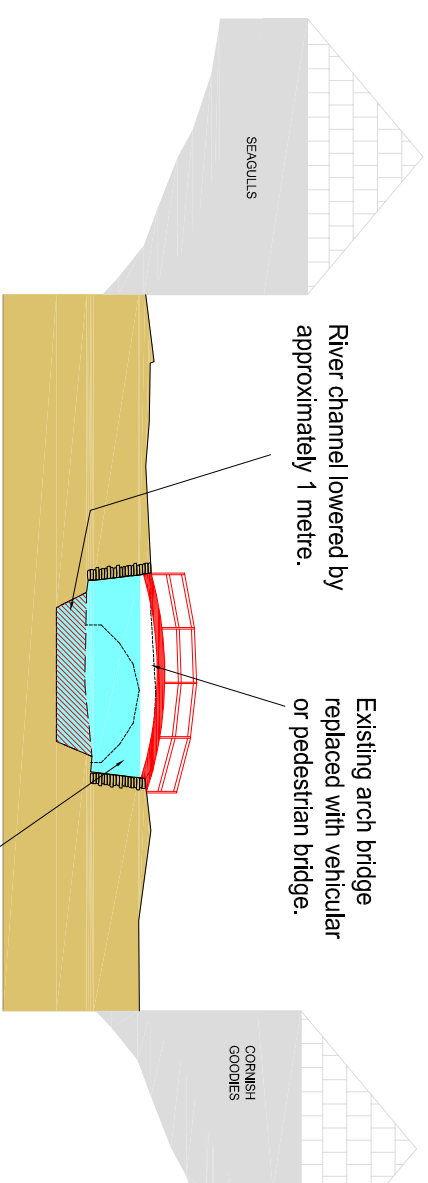

SECTION No. 4
11m Upstream of lower bridge removed.

Sewer in bank lowered, crossing removed.

River channel lowered by approximately 1 metre.

Ground levels lowered by approximately 0.5 metre.

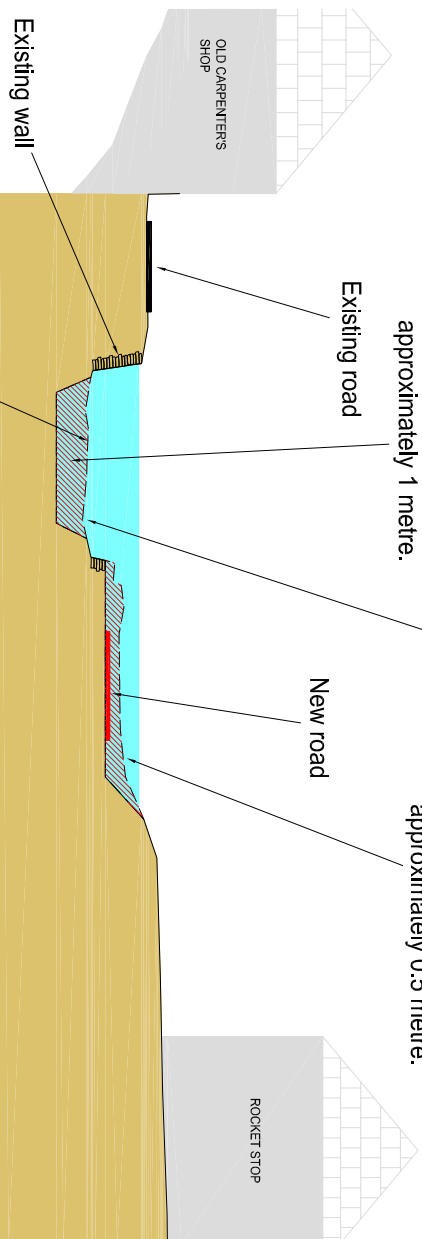

SECTION No. 5
Between Main Road Bridge and Lower Bridge

Reinforced earth bank or flood wall. Location to be determined through consultation.

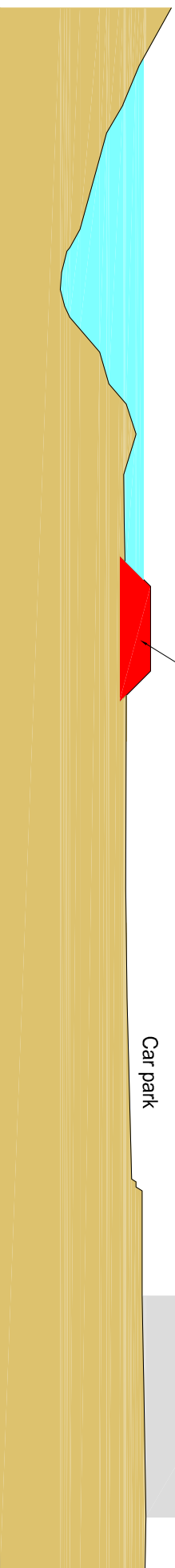

SECTION No. 10
Adjacent to Boscastle Newspapers

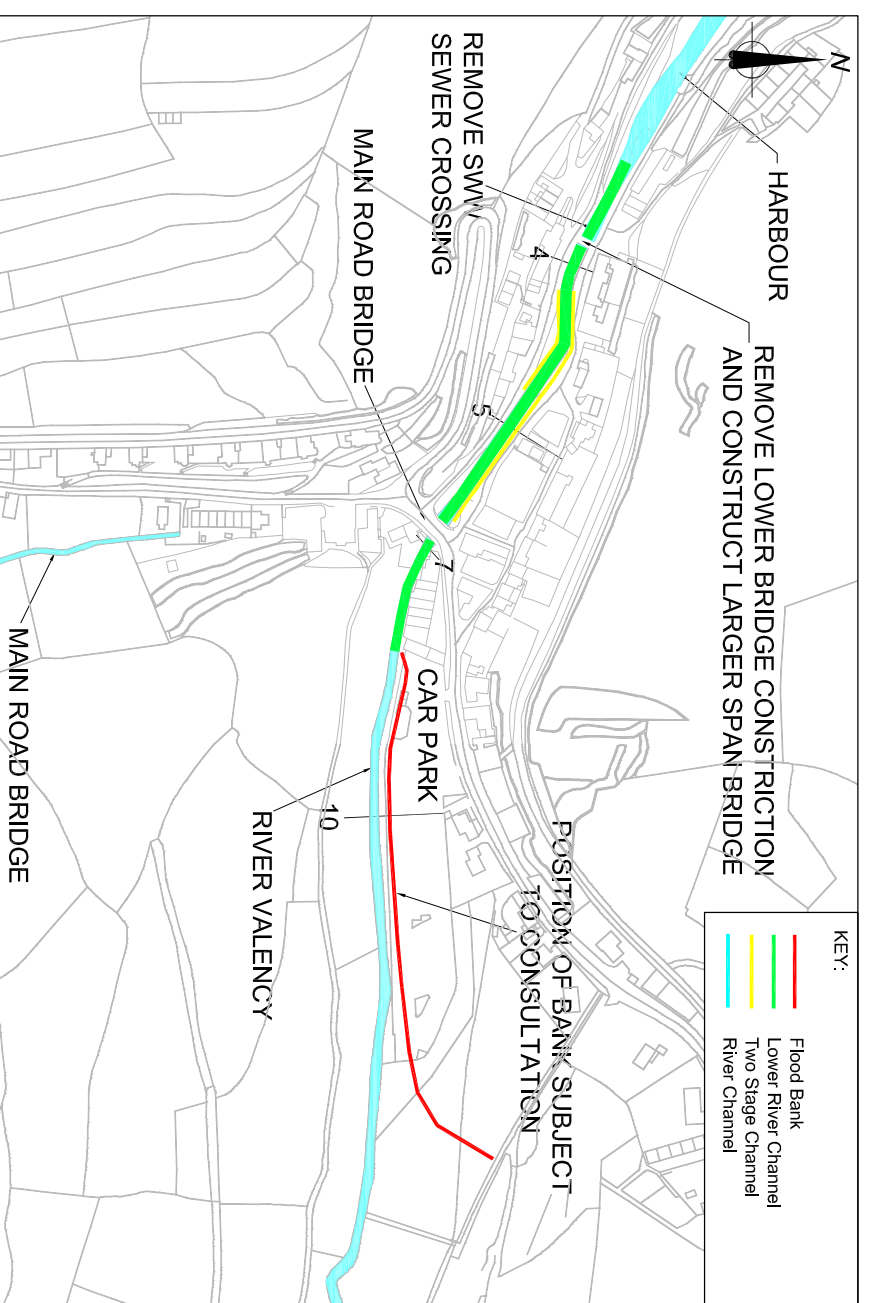

PLAN
Not to scale

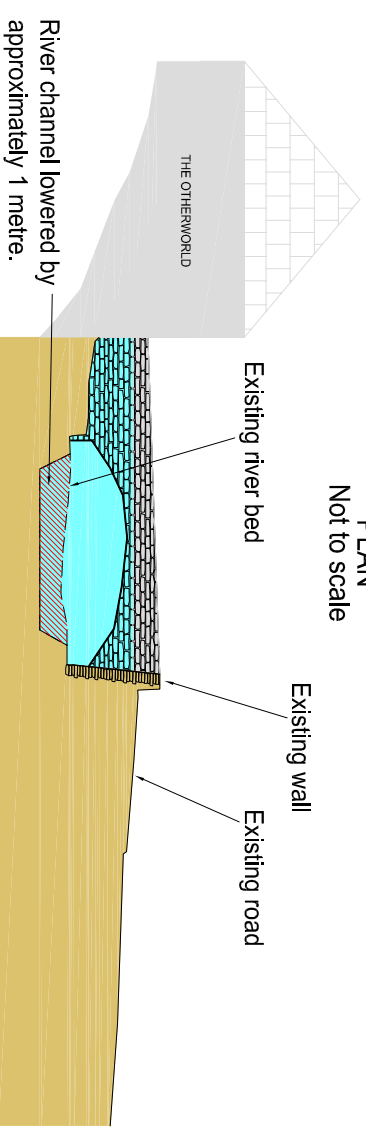

SECTION No. 7
Upstream face of main road bridge

NOTE:
These drawings show outline options which are currently being considered as part of the Environment Agency's flood defence pre-feasibility study. They are for information only - the development of these options is at a relatively early stage. National funding will be required to fund construction.

Rev	By	Check	Approved	Date	Description



Halton Group Limited
 1st Floor, 100, The Old Mill, Easton Business Park, Easton, EX1 1SN
 Tel: +44 (0) 1382 44252 Fax: +44 (0) 1382 44031
 Email: info@halton.com
 www.halton.com



Project
BOSCASTLE FLOOD DEFENCE SCHEME

Drawing
POTENTIAL FLOOD MITIGATION WORKS OPTION 5

Drawn by: ARW	Date: 8/4/05
Checked by: TW	Date: 8/4/05
Approved by: SMW	Date: 8/4/05
Drawing No:	Revision
WB/BOSJ/104	

PRELIMINARY

Drawing Scale: NOT TO SCALE